



# CITO Rule Puller

Operation & Maintenance Manual



# CITO Rule Puller

## Index

### Index

• Field of Application	3
• Product Appearance	3
• Product Description	4
• Product Dimensions & Weight	4
• Product Components Explanation	4
• Hazard Warning Signs	5
• Safety Precautions	6
• Assembly Drawings	6
• Technical Specifications	7
• Installation Instructions	7
• Layout for Working Stations	7
• Operation Explanation	8
• Product Functions Explanation	8
• Care & Maintenance	9
• Lubrication	10
• Transport	10
• Storage	10
• Remarks	10
• Disclaimer	10

### Spare Parts List

description	order no.
Jaws	BQS00021
Jaws (narrow, for rule distances under 6 mm)	BQS00022

# CITO Rule Puller

## Field of Application

### Field of Application

- 1) The Rule Puller is designed to pull steel rules from cutting boards. This tool is not suitable for any other function.
- 2) The Rule Puller has to be operated in a die-room and used directly on the cutting board.

### Product Appearance



# CITO Rule Puller

## Details

### Product Description

- 1) The Rule Puller is a manual device to pull the rules from the cutting board vertically.
- 2) The Rule Puller pulls rules from the board without widening the gaps, to make sure that they can be used again.
- 3) Enhances work efficiency and assures operators safety.

### Product Dimensions & Weight

Height	410 mm
Length	100 mm
Width	30 mm
Weight	1,6 kg

### Product Components Explanation

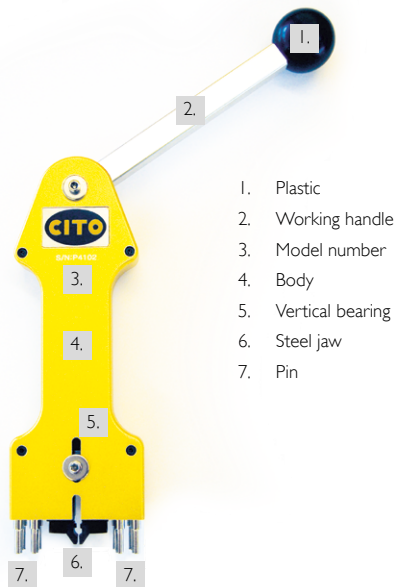

1. Plastic
2. Working handle
3. Model number
4. Body
5. Vertical bearing
6. Steel jaw
7. Pin

# CITO Rule Puller

## Hazard Warning Signs

### Hazard Warning Signs

- 1) The Rule Puller is a manual instrument. The operator should handle it with care and not insert fingers into the bruise area.
- 2) To avoid injuries, irrelevant personnel should be kept away from the Rule Puller.

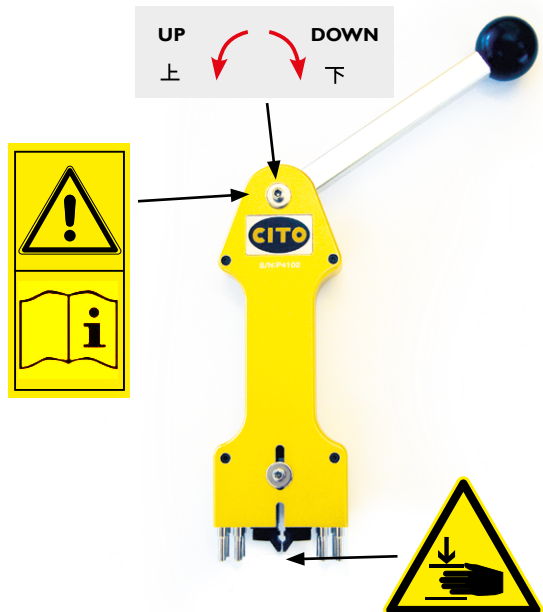

# CITO Rule Puller

## Safety Precautions

### Safety Precautions

#### Steel jaws

- 1) The jaws are made of heat-treated special tool steel. Before using the puller, make sure the screws (holding the jaws) are screwed tightly, otherwise, the screws might break.
- 2) If more than 600 lbs pressure is applied to the puller handle, the screws (holding the jaws) and the jaws might break.

#### Choose the correct position for pulling

- 1) When you pull the steel rule out of the die-board start with the first pull at approximately  $\frac{1}{4}$  from one end of the steel rule, then move approximately  $\frac{1}{4}$  and pull for the second time, and so on. This is the easiest and safest way to pull a steel rule out of a die-board.

**Note:** Take this advice seriously, and pull the steel rules step by step out of the die-board. Trying to pull a rule out with just one pull damage the jaws and increase the risk of being injured.

### Assembly Drawings

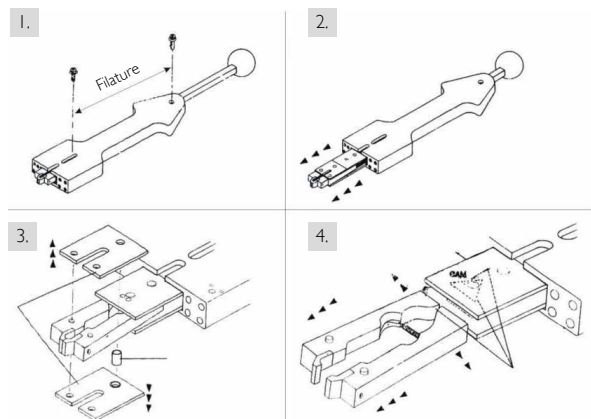

# CITO Rule Puller

## Specifications

### Technical Specifications

- 1) Suitable for thickness of 2-4 pt. steel rules.
- 2) Thickness of the board: between 15 mm and 18 mm.

### Installation Instructions

- 1) Please install the plastic handle before using.

### Layout for Working Stations

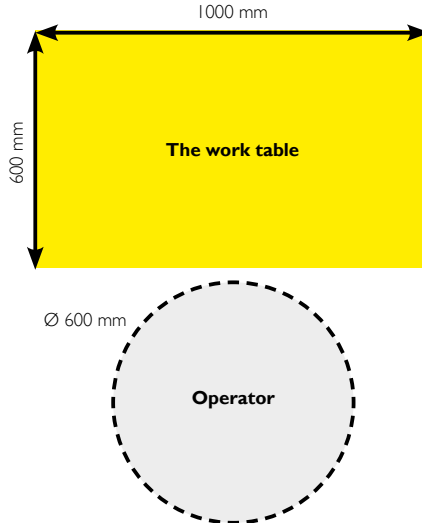

# CITO Rule Puller

## Operation Explanation

### Operation Explanation

- 1) Aim the steel jaw at the steel rules.
- 2) Use one hand to press the handle down, and use another hand to firmly grasp the Rule Puller and then the vertical pulling will be achieved easily.

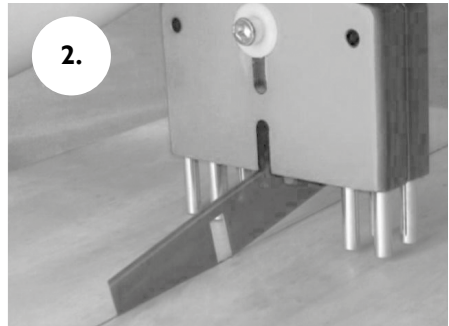
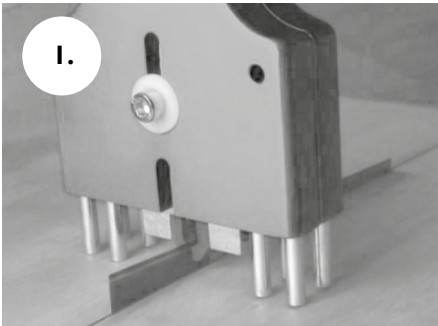

### Product Functions Explanation

- 1) Pulls steel rule vertically, so the board will take no damage.
- 2) The eight pins (feet) are movable, so the Rule Puller can be used on different boards.
- 3) During operation, hands should be kept away from the steel rule, in order to avoid injuries.
- 4) The jaws are durable and can be replaced easily.
- 5) The machine can be operated easily by both left-handed and right-handed users.

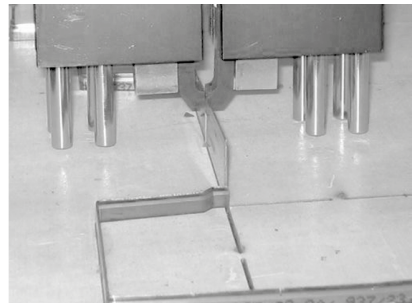
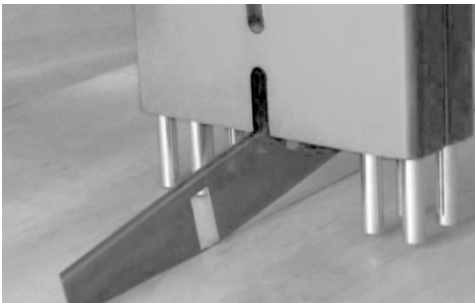



# CITO Rule Puller

## Care & Maintenance

### Care & Maintenance

- 1) The steel jaws are goods of wear and tear. Generally after half a year of usage, it is required to replace the steel jaws (depending on customer's usage frequency).
- 2) After a very long period of time of usage, the white rubber washer and the iron washer will present attrition (depending on the pressure used when adjusting the screws).
- 3) Each Rule Puller contains an extra pair of steel jaws and a pair of spacer.
- 4) Contact with the dealers to order new accessories.

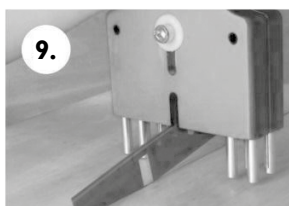
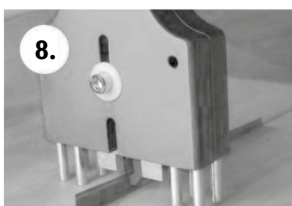
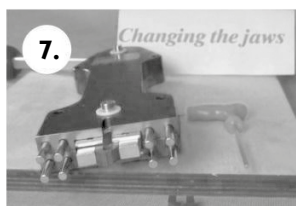
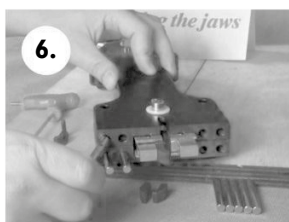
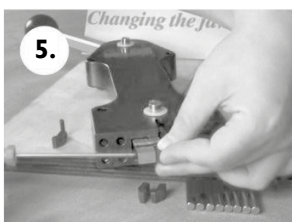
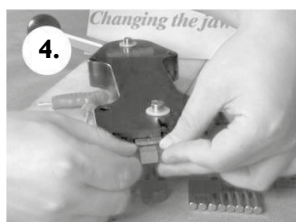
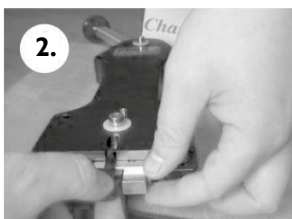
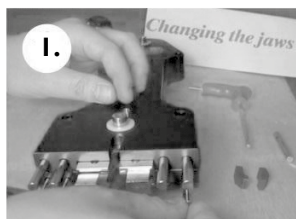

Diagrams of steel jaws replacement

# CITO Rule Puller

## Hints

### Lubrication

- 1) Lubrication is not necessary for the Rule Puller.

**Note:** avoid using under humid conditions in order to prevent the steel jaws from rusting.

### Transport

- 1) Hold the handle and main body while moving, and avoid letting the Rule Puller fall onto the ground, which may injure hand and foot.

### Storage

- 1) The Rule Puller should not be placed and stored under humid condition or exposed to sunshine and rain in order to avoid rusting.
- 2) The Rule Puller should be placed in a die-room with in-door temperature and humidity.

### Remarks

- 1) The manufacturer reserves the right to alter the content of the operation & maintenance manual at any time.

### Disclaimer

- 1) Before use, please read the operation & maintenance manual carefully.
- 2) The manufacturer or re-seller of the Rule Puller is not responsible for any claim arising from operator's negligence or careless use of Rule Puller.
- 3) The manufacturer or re-seller of the Rule Puller further disclaims responsibility for claim of loss and damage arising from improper use of the Rule Puller.
- 4) Using the Rule Puller implies that the operator has read and agreed to the terms listed in the operation & maintenance manual.

MEA00079

